

Quad'UP EVOLUTION

PRODUCT +

Easy tool less and quick assembly thanks to:

- its entirely mounted automatic catches. **1**

- its 4 legs, quick to install, which perfectly fit the ground. They can be folded to pass doors **2**

- its platform which can be fixed on the rungs at different heights. **3**

Mobile: equipped with 4 swivel castors with brakes for an easy maneuvering. **4**

Modular: the height of its structure is evolutive in order to optimize the ratio of height to size of the product. Ideal to work under the rafters.

Level compensation.

Aluminium structure with tubular profiles.

4 steel legs with non-slip feet.

Platform in non-slip wood fixed on notched profile and equipped with a trapdoor which closes automatically. Size 1,30 x 0,46 m.

Assembly secured by 2 locking hooks.



QUICK ASSEMBLY

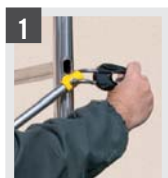

Only a quarter-turn to fix rails and diagonal braces.



LEVEL COMPENSATION

Delivered packed with facing.



2

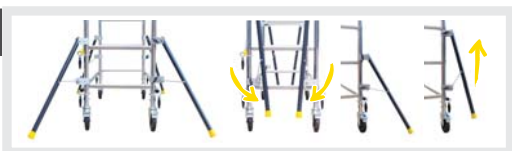

4



NEW INTERMEDIARY HEIGHT

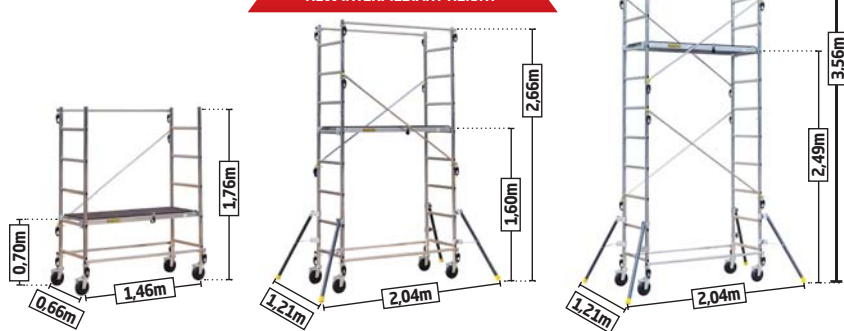

NEW!

QUAD'UP EXTENSION

Working height : 6,80 M

Parcel content:

- 2 ALUMINIUM LADDERS tubular profile
- 1 PLATFORM to be installed directly on the ladder rungs
- 4 RAILS + 2 ALUMINIUM DIAGONAL BRACES equipped with automatic handles already mounted
- 4 HEIGHT ADJUSTABLE SWIVEL ALUMINIUM side support

Item code : 347 705
Gencod 3172963477056
Weight: 26,60 kg

5 years warranty.

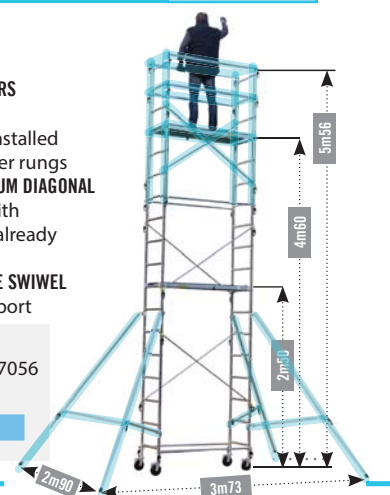

Maximum intended load 150 kg

Domestic use material

| Item code | | | | | |
|-----------|---------------|------|------|--------------------|-------|
| 347703 | 3172963477032 | 2,50 | 4,70 | 3,56 x 2,05 x 1,26 | 37,20 |
| | | (m) | (m) | (m) | (kg) |
| | | | | | (m) |

Standard
5 years warranty